

HEAVY DUTY LUGS FOR COMPACTED XLPE CABLE

Table 2

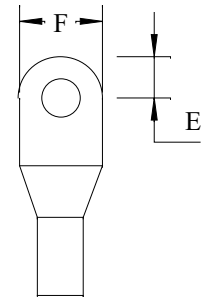
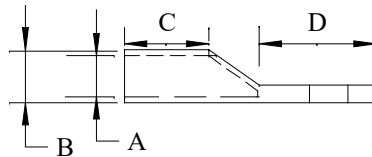

Product Information:

Nominal Lug Size **SABS 1339-1981 Nominal Diameter Over Conductor** **Stud Size**

Nominal Dimensions (mm)

Barrel

Spade

(mm ²)	(mm)	(mm)	I.D A	O.D B	Length C	Length D	Hole Pos. E	Width F
35	7,10	-	7,30	10,50	16,00	24,00	11,00	19,00
50	8,50	-	8,75	12,30	20,00	24,00	11,00	19,00
70	10,10	-	10,40	14,60	21,00	27,00	14,00	20,00
95	11,80	-	12,15	17,00	24,00	28,00	14,00	24,00
120	13,20	-	14,00	19,10	26,00	28,00	14,00	26,00
150	14,80	-	15,25	21,30	31,00	37,00	18,00	30,00
185	16,40	-	17,00	23,70	34,00	40,00	19,00	33,00
240	18,70	-	20,00	27,10	34,00	41,00	19,00	37,00
300	20,90	-	21,63	30,50	38,00	48,00	20,00	42,50
400	24,10	-	24,50	34,64	51,00	49,00	23,50	48,00
500	27,00	-	27,50	38,90	51,00	52,00	25,00	54,00
630		-	33,00	45,00	53,00	65,00	28,00	64,00

Complete your Project:

Please select the items you require and we will be in touch

Cables and Wires:

Indoor
Outdoor
General
Other
Let an ACTOM
Specialist Contact you

Lighting:

Indoor
Outdoor
General
Other
Let an ACTOM
Specialist Contact you

Transformers (Distribution):

Indoor
Outdoor
General
Other
Let an ACTOM
Specialist Contact you

Accessories:

Indoor
Outdoor
General
Other
Let an ACTOM
Specialist Contact you

Specific Information:

Address: 4 Branch Road, Germiston 1401, P.O. Box 678, Germiston 1400

For more Information on this Product Please Send us the Following

Product Information:

Product Name:

Quantity:

Project Name:

Date the Product is required:

Your Contact Information:

Name and Surname:

Company:

Email:

Phone Number:

Province:

Thank You

For having a Look at this Product

Please send this PDF back to us with all your Information

Scan the QR Code to visit our Website:

